

PG11

Pneumatic Angular Grippers

- High performance
- Strong body structure
- Steel gripper with less space
- Speed adjustment on the body
- Easy fixing with prepared holes
- Easy air pipe connections
- Magnetic sensor adaptation on "C" or "T" channel
- Applied for clamping and moving

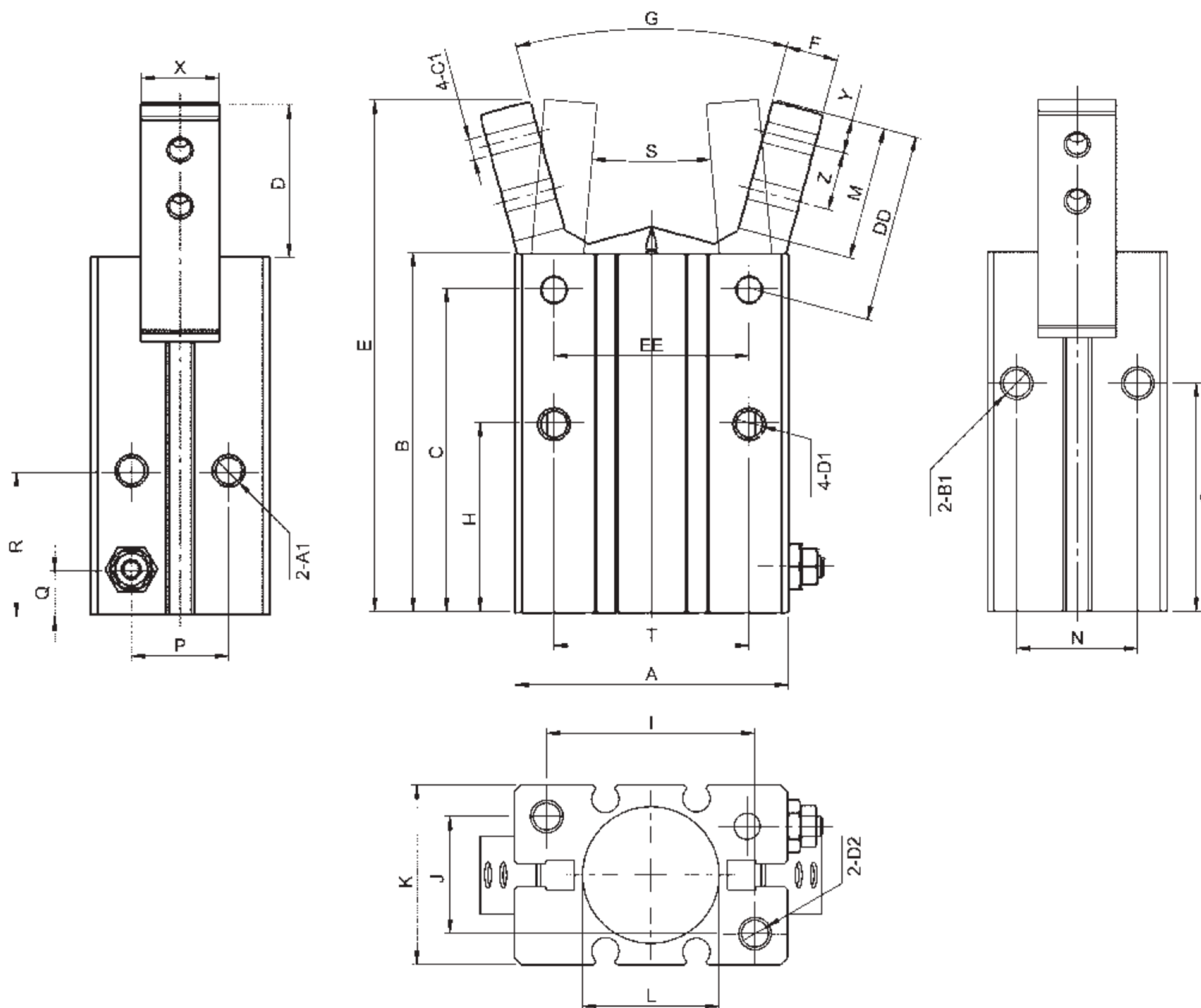

Order No	A	A1	B	B1	C	C1	D	DD	D1	D2	E	EE	F	G	H	I	J	K	L	M	N	O	P	Q	R	S	T	X	Y	Z
PG11/10	23	M3	38.6	M3	35.8	M2.5	14.2	17.2	M3	M3	52.8	14	4	30°	23	18	12	16.4	Ø11	12.5	11.4	27	10	6.5	18.8	10°	16	7.4	3	5.7
PG11/16	30.6	M5	44.6	M4	39.7	M3	18.9	23.6	M4	M4	63.5	24	7	30°	24.5	22	15	23.6	Ø17	16.5	16	30	13	6.5	18.3	10°	24	10	4	7
PG11/20	42	M5	55.2	M5	49.7	M4	23.5	29	M5	M5	78.7	30	8	30°	29	32	18	27.6	Ø21	20.5	18.6	35	15	7	22.2	10°	30	12	5.2	9
PG11/25	52	M5	60.4	M6	54.8	M5	32.8	38.5	M6	M6	93.2	36	10	30°	30	40	22	33.6	Ø26	27.5	22	36.5	19.5	7.4	23.5	10°	36	12	8	12

(mm)